



The Corniche

23 Albert Embankment, SE1 7GG

£950 Per Week



Floor Plan

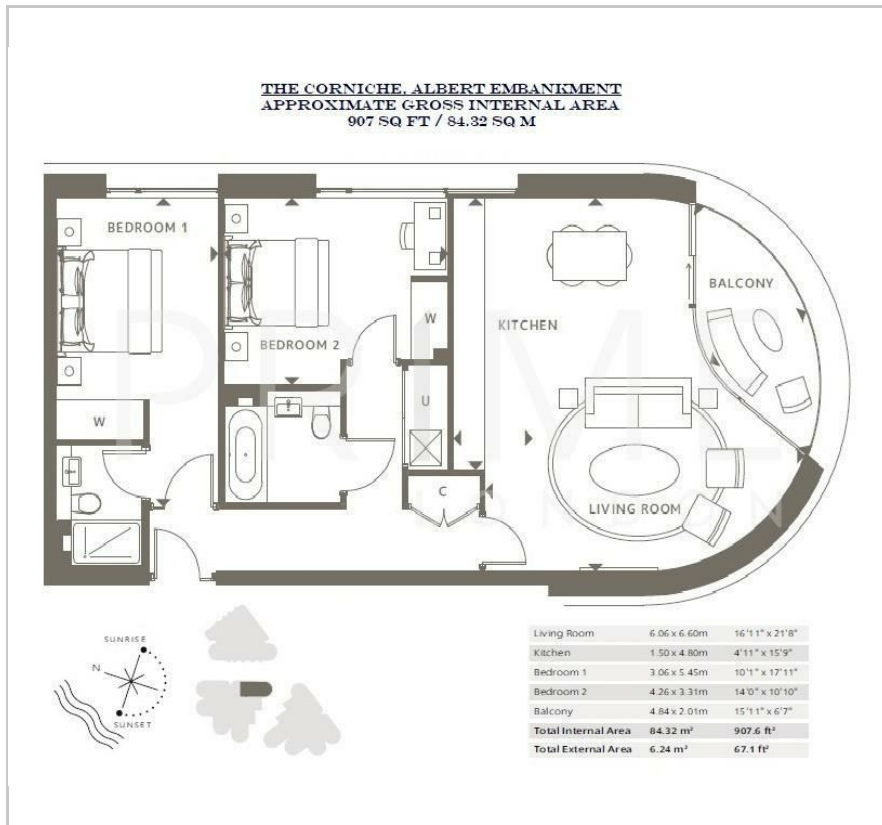

Area Map

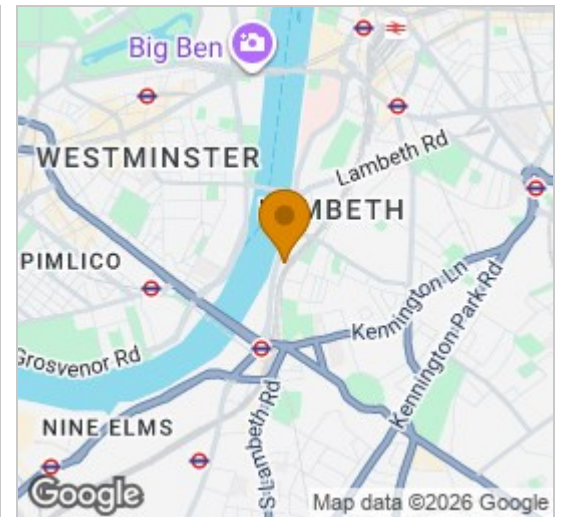

Energy Efficiency Graph

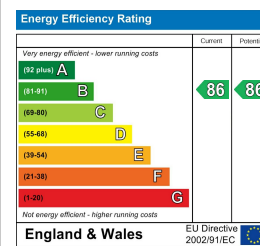

Viewing

By appointment. Contact us on 0207 928 6663 if you wish to arrange a viewing appointment for this property, or require further information.

- Two bedroom apartment
- Private balcony
- Gym, spa, pool, and Sky Lounge
- 907 sq ft (84.32 sqm)
- Luxurious furnishings
- 24 hour concierge

This elegant two bedroom apartment, with private balcony, luxurious furnishings and excellent finishes is available to lease through Prime London in The Corniche, 23 Albert Embankment.

The development includes extensive residents facilities including a gym, spa, swimming pool, cinema and bowling alley as well as a residents' club and bar with stunning roof terrace overlooking Big Ben and the Houses of Parliament.

Located in a prime position on the bank of the River Thames, The Corniche (designed by Foster & Partners) is within short reach of many of London's landmarks, not only the Houses of Parliament and the River Thames, but also the Tate Britain and London Eye.



These particulars, whilst believed to be accurate are set out as a general outline only for guidance and do not constitute any part of an offer or contract. Intending purchasers should not rely on them as statements of representation of fact, but must satisfy themselves by inspection or otherwise as to their accuracy. No person in this firm's employment has the authority to make or give any representation or warranty in respect of the property.